

PaperStream Capture Pro

Simplify your data-entry tasks with PaperStream Capture Pro. Automate repetitive tasks with high accuracy and reliability. Access hand-print OCR, form separation, and a broad selection of integrations. Choose PaperStream Capture Pro Premium to gain production scanner compatibility and the file import function. The PaperStream Capture product family can help you work better, finish faster, and get more done with your data.



Key Benefits

Automate Data Entry Tasks

Automate tedious data-entry tasks and form-based workflows to complete jobs securely, quickly, and accurately.

Integrate with Desired Destinations

An expansive array of integrations lets you securely deliver your information where and how you want it, so it's there when you need it.

Get Quality Results Quickly with Advanced QC

Image Check and Assisted Scan help you identify and address multi-feeds and poor images without the time and hassle of rescans.

Integrations/Destinations

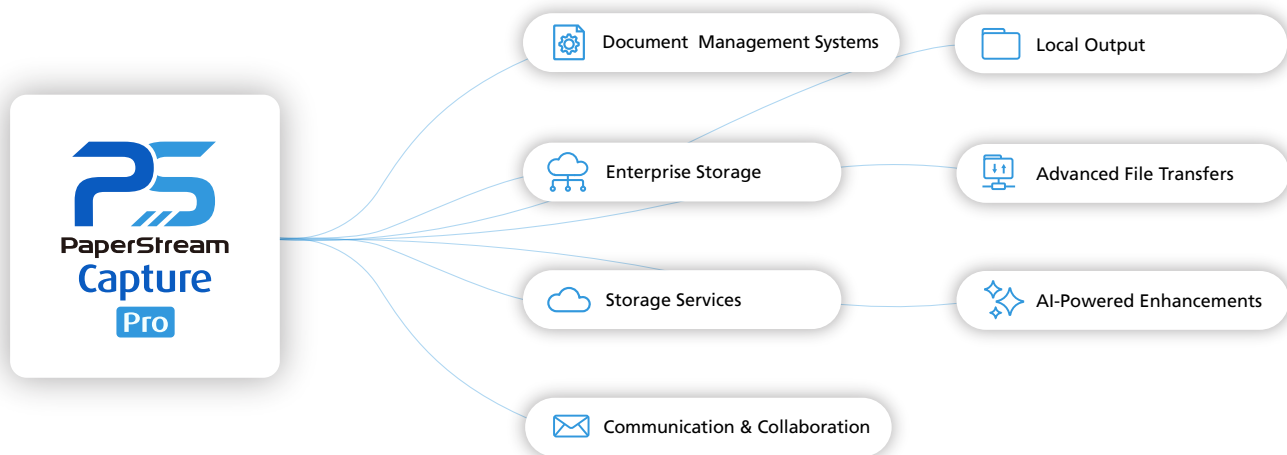

Designed with ease of use in mind. Your capture software shouldn't be a source of stress or a heavy IT lift.

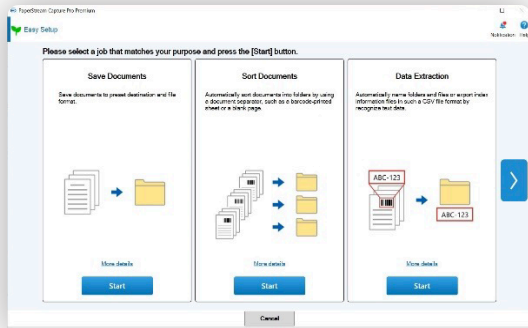

Easy Setup

Getting started is simple. Let Easy Setup guide you through the most common tasks or step into advanced settings as an admin or experienced user. Helpful for easy onboarding and employee adoption.

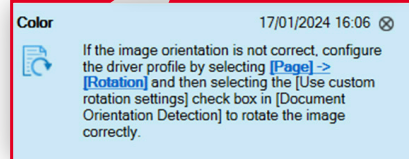
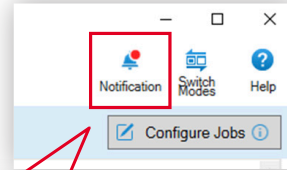

Setting Assistant

You don't have to be an IT expert to get great results with PaperStream Capture Pro. Setting Assistant recommends adjustments to optimize your workflow. Enjoy digital guidance to enable page rotation and blank page removal. Helpful to catch overlooked blank pages and improperly oriented documents.

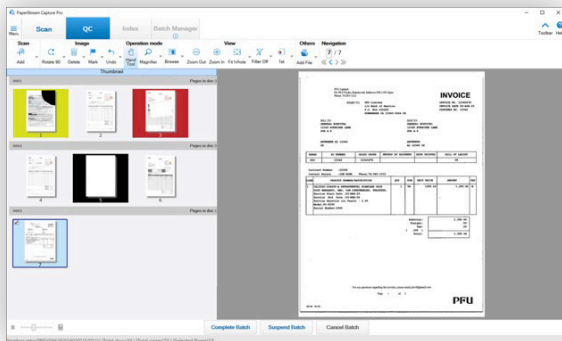
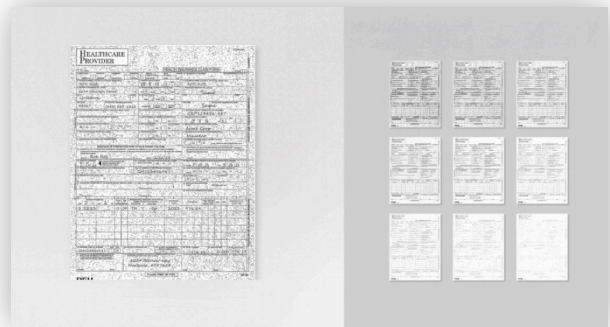

Image Check

Image Check is like having an extra set of eyes. PaperStream Capture Pro uses color-coded notifications to alert operators to address potential issues, like paper damage or image noise, before the next step in the document workflow. Helpful to avoid business process interruption.



After Scan Correction

Getting the best image is a no-brainer. After Scan Correction generates multiple optimized images of scanned documents so you can choose which one is right. Helpful for business continuity, avoiding rescans, and ensuring highest quality output.

Optimized for streamlined workflows. Automate form processing, redact sensitive information, and make your archives actionable.

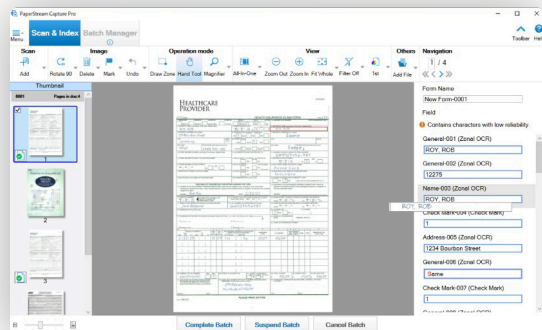

Automated Forms Processing

Simplify and shorten manual data-entry tasks for form processing. Automate data collection for up to 100 fields per form, process multiple types in the same batch, and gain expanded recognition technology with hand-print recognition (AI-OCR). Helpful to improve form-intensive workflows.

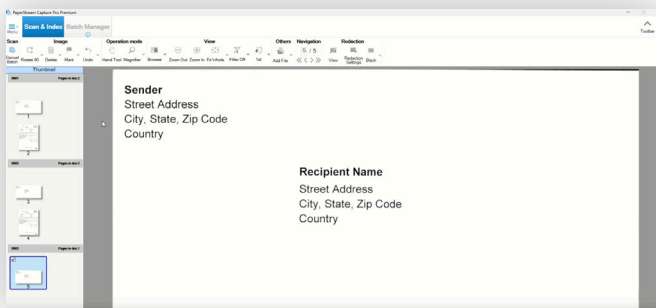

Envelope Separation

Mailroom magic delivers document separation the way you need it. Batch better and more efficiently, every time. No patch codes or manual work are needed when document files are separated by envelopes. Helpful for time savings and labor relief.



Redaction Function

Protect personally sensitive information by redacting it. The Redaction Function is meant to prevent the unauthorized visibility of the data in selected fields in subsequent workflow steps. Helpful for forms that collect personal information, such as applications and invoices.

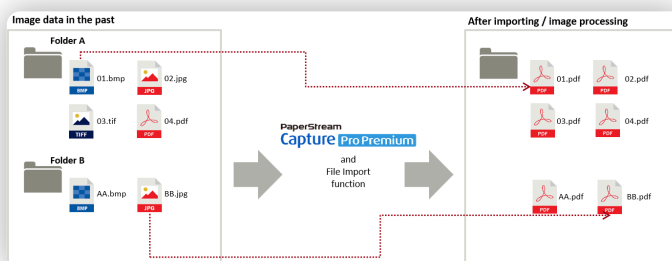

File Import

Make your existing digital files work for you. Import image-based scanned documents directly into your capture workflow to extract valuable data and improve searchability. (BMP, PNG, PDF, JPEG, TIFF file types) Helpful for companies to access untapped archived information.

Specifications for PaperStream Capture Pro / Pro Premium

Supported Scanners	PaperStream Capture Pro	fi-70F / fi-7300NX / fi-7480 / fi-7460 / fi-800R / fi-8040 / fi-8150 / fi-8170 / fi-8190 / fi-8250 / fi-8270 / fi-8290 / SP-1120N / SP-1125N / SP-1130N / SP-1425 Discontinued models: fi-5530C2 / fi-6110 / fi-6130Z / fi-6140Z / fi-6230Z / fi-6240Z / fi-65F / SP-1120 / SP-1125 / SP-1130 / fi-7030 / fi-7140 / fi-7160 / fi-7180 / fi-7240 / fi-7260 / fi-7280
	PaperStream Capture Pro Premium	All Ricoh fi Series document scanners
Supported OCR Languages		Supported languages are English, French, German, Italian, Spanish, Chinese (Simplified), Chinese (Traditional), Japanese, Russian, Korean, Turkish, Greek, Vietnamese, Portuguese, Arabic, Swedish, Dutch, Polish, Czech, Romanian, Hebrew, Ukrainian, Thai, Indonesian, Danish, Norwegian, Hungarian, and Finnish.
Scanner Driver		PaperStream IP TWAIN
Document Separation		Blank page (single /duplex), Page count, Zonal OCR, Patch code, Barcode (1D /2D), Press Ctrl, Specific document (Automatic, Profile Selection), Specific Form, Envelope document separation, File name**
Save-to Destinations		Folder, Network folder, SharePoint, SharePoint Online, FTP/SFTP, E-mail (SMTP / Attachment), Printer, Other App. Cloud services (Microsoft OneDrive/Dropbox/ Google Drive/Box), Internet FAX (via SMTP)
Output File		Bitmap, TIFF, Multi-TIFF, JPEG, JPEG2000, Searchable PDF, PDF, PDF/A, PNG, RTF, Word, Excel, PowerPoint
Output Index File		XML, CSV, TXT
Extracted Data		Barcode (1D / 2D), Zonal OCR, Manual Entry, System, Choice List, Database Autofill, Combination, Split Barcode, JSON Parsing, JSON Value, Passport, ID Card (TD1 and TD2), OMR Field Grouping
Data Extraction Fields (Maximum supported number)		100
Form Fields (Maximum supported number)		150
Indexing		By Document or Page
Field Rule / Masking / Redaction		Yes
Other Functions		For PaperStream Capture Pro/Pro Premium: Assisted Scan, After Scan Correction ⁴ , Import ³ /Export System Settings, Multi-Station Operation ⁵ , Rubber-band Redaction Annotations, Scan Job Profile Grouping For PaperStream Capture Pro Premium ONLY: File Import
Supported Operating System		Windows® 11, Windows® 10, Windows® Server 2022, Windows® Server 2019, Windows® Server 2016
Hardware Requirements	CPU ⁶	Intel or Intel-compatible processors
	Display Resolution	1024 x 800 Pixels or more, and 65,536 colors or more
	Disk Capacity	10 GB or more ⁷
Software		Microsoft .NET Framework 4.7.2 or later, Microsoft Internet Information Service 10.0 or later

¹ Available only on import function as option. ² Available when PaperStream Connector Option is installed. ³ *PaperStream Capture Pro Premium * is required to use file import. ⁴ After Scan Correction. ⁵ It is necessary to install at least one Scan Station or QC / Index Station in addition to the PaperStream Capture Pro Scan Station, since 2 or more stations are required in total to configure the *Multi-Station function*. ⁶ Scanning speeds may vary due to the system environment. ⁷ Enough disk capacity is necessary for the saved file when scanning. * requires PaperStream Capture Pro Premium